

# Moonroof

## Glass Bracket/Sunshade Replacement

1. Remove the glass (see page 20-37).
2. Remove the screws and drain channel by sliding it forward.

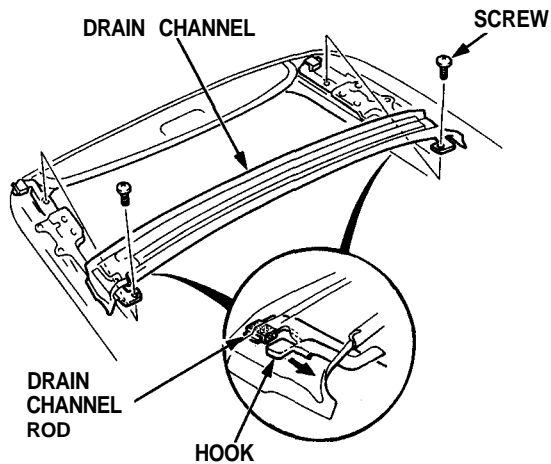

3. Using the moonroof wrench, move the glass bracket to the position where the glass bracket normally pivots down, and remove the screws.

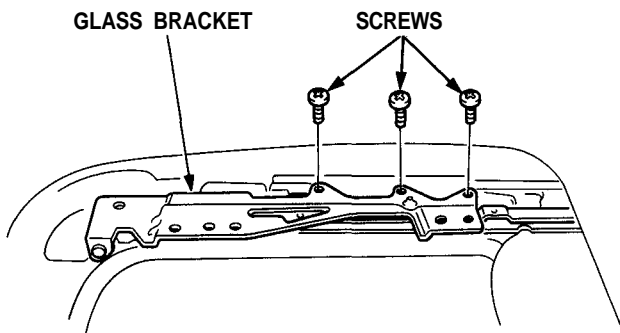

4. Remove the nut and screw. Lift and remove the rail holder.

NUT  
6 x 1.0 mm  
9 N·m (0.9 kg-m,  
6.5 lb-ft)

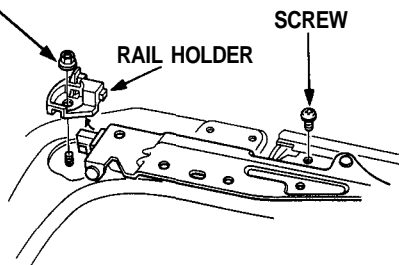

5. Remove the drain channel rod slider by moving the cable slider forward using the moonroof wrench.
6. Detach the drain channel rod stopper from the cut-out of the guide rail.

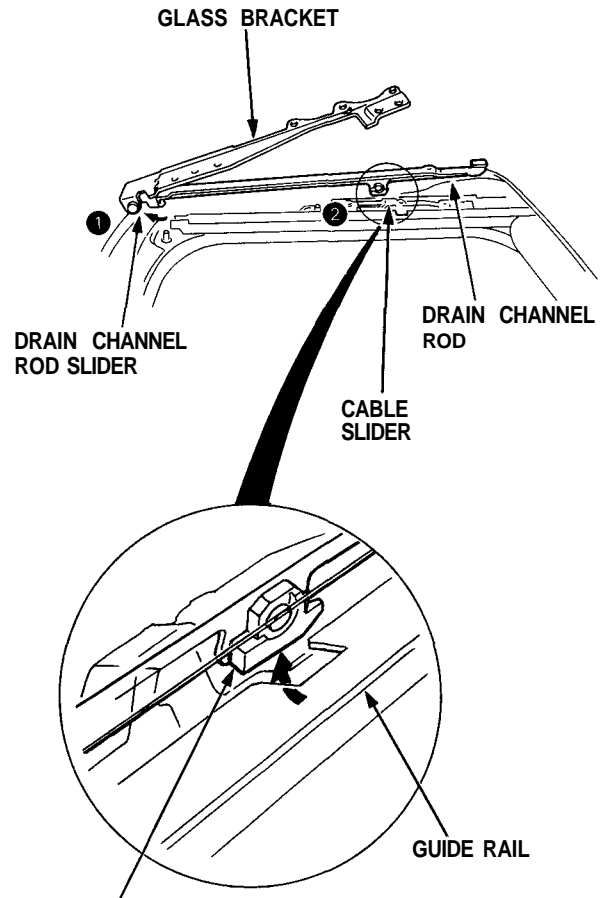

Rotate as shown to remove it from the guide rail.



7. Slide the sunshade forward, then remove it.

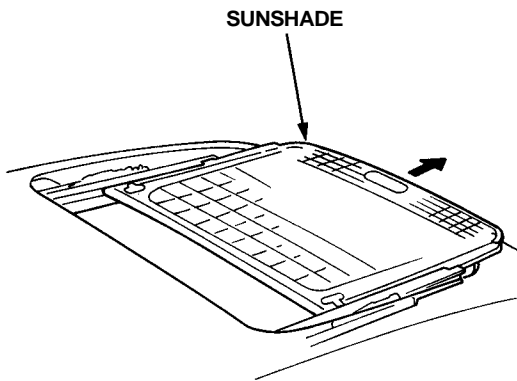

8. Install the sunshade in the reverse order of removal.  
Make sure the sunshade moves smoothly.

## Guide Plate Replacement

1. Remove the glass bracket.
2. Pry the E-clips and remove the shafts, then separate the glass bracket and drain channel rod.

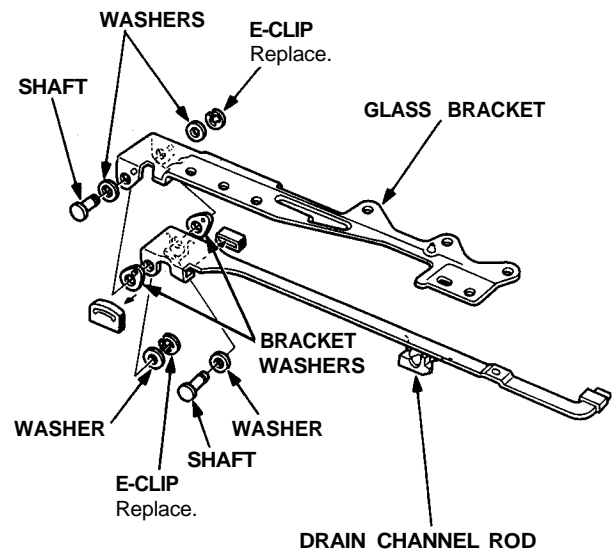

3. Remove the guide plate from the lift-up stopper.

